

TIGE CHROMÉE USINÉE POUR VERIN SIMPLE ET DOUBLE EFFET
TURNED CHROMED ROD FOR SINGLE/DOUBLE ACTING CYLINDERS

SBFG

Series M250

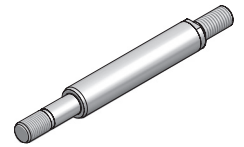
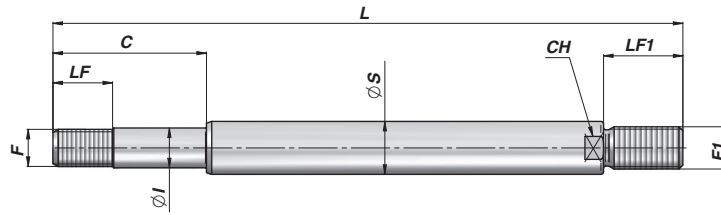

Code Code	ØS	Alésage Bore	Course Stroke	L	Øl	C	F	LF	F1	LF1	CH	kg
SBFG200400100	20	40	100	238	15	58	M14x1,5	23	M16x1.5	30	18	0,60
SBFG200400200			200	338								0,74
SBFG200400300			300	438								0,98
SBFG200400400			400	538								1,23
SBFG200400500			500	638								1,47
SBFG300500100	30	50	100	258	20	65	M20x1,5	30	M20x1.5	40	26	1,10
SBFG300500200			200	358								1,65
SBFG300500300			300	458								2,20
SBFG300500400			400	558								2,75
SBFG300500500			500	658								3,30
SBFG350600100	35	60	100	285	24	75	M24x2	35	M27x2	50	32	1,68
SBFG350600200			200	385								2,43
SBFG350600300			300	485								3,18
SBFG350600400			400	585								3,95
SBFG350600500			500	685								4,68
SBFG400700100	40	70	100	297	27	75	M27x2	30	M30x2	60	36	2,26
SBFG400700200			200	397								3,25
SBFG400700300			300	497								4,26
SBFG400700400			400	597								5,25
SBFG400700500			500	697								6,25
SBFG500800100	50	80	100	328	27	83	M27x2	38	M36x2	70	45	3,51
SBFG500800200			200	428								5,12
SBFG500800300			300	528								6,65
SBFG500800400			400	628								8,18
SBFG500800500			500	728								9,71
SBFG501000100	50	100	100	355	33	88	M33x2	43	M36x2	70	45	4,18
SBFG501000200			200	455								5,70
SBFG501000300			300	555								7,25
SBFG501000400			400	655								8,79
SBFG501000500			500	755								10,33

MATERIEL : ACIER UNI C45 SAE 1045 - CHROME 25 µm ±5 Rating 9 / 200h (<ø20 120h) ISO 10289 - 1999/ISO 9227-NSS
MATERIAL : STEEL UNI C45 SAE 1045 - CHROME 25 µm ±5 Rating 9 / 200h (<ø20 120h) ISO 10289 - 1999/ISO 9227-NSS