

AFIO

AFCR

FILTRE RETOUR SEMI PLONGE  
RETURN-LINE FILTER

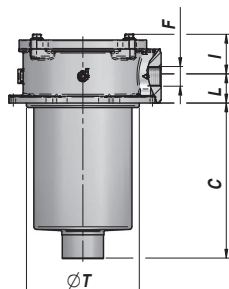
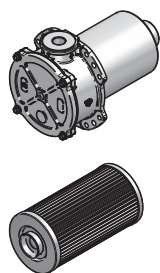

AFIO

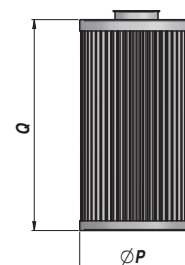
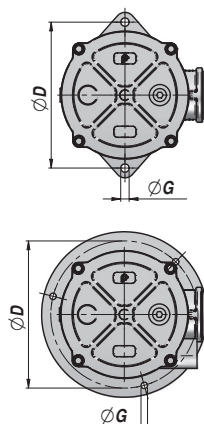

AFCR

AFIO		FILTRE COMPLET COMPLETE FILTER									
Code Code	Type Type	l/min max	kg	F BSP	ØT	C	L	I	ØD	ØG	
AFIO030010	HF502-10.060 RP010	25	0,43	1/2"	66.5	83	20.5	34	89	M6	
AFIO030030	HF502-10.060 RP025	45	0,43								
AFIO050030	HF502-20.077 RP025	65	0,96	1/2"	87.5	103	28.5	44.5	115	M8	
AFIO050060	HF502-20.077 MI060	70	0,96								
AFIO060030	HF502-20.077 RP025	75	0,96	3/4"	87.5	103	28.5	44.5	115		
AFIO080010	HF502-20.122 RP010	75	1,07								
AFIO080030	HF502-20.122 RP025	95	1,07	3/4"	87.5	148	28.5	44.5	115	M8	
AFIO080060	HF502-20.122 MI060	90	1,07								
AFIO100000	HF502-20.122 MS090	105	1,07	1"							
AFIO100010	HF502-20.122 RP010	75	1,07	1"							
AFIO100030	HF502-20.122 RP025	100	1,07	1"	87.5	148	28.5	44.5	115	M8	
AFIO100060	HF502-20.122 MI060	100	1,07	1"							
AFIO10061	HF502-20.122 MI060	90	1,07	3/4"							
AFIO150010	HF502-30.195 RP010	190	2,24	1"	129	230	35.5	53	175	M10	
AFIO150030	HF502-30.195 RP025	210	2,24								
AFIO180000	HF502-30.195 MS90	270	2,24	1 1/4"	129	230	35.5	53	175	M10	
AFIO180030	HF502-30.195 RP025	270	2,24								
AFIO200010	HF502-30.239 RP010	230	2,46	1 1/4"	129	273	35.5	53	175	M10	

AFCR		CARTOUCHE ELEMENT					
Code Code	Type Type	Pour AFIO Type For AFIO Type	µm	ØP	Q	kg	
AFCR003577	HEK02-20.122 RP010	HF502-20.122	10	70	140	0,32	
AFCR003584	HEK02-20.122 RP025	HF502-20.122	25	70	140	0,32	
AFCR010151	HEK02-30.195 MI060	HF502-30.195	60	99	212	0,72	
AFCR010191	HEK02-30.195 RP025	HF502-30.195	25	99	212	0,72	
AFCR030000	HEK02-10.060 MS090	HF502-10.060	90	52	75	0,12	
AFCR030030	HEK02-10.060 RP025	HF502-10.060	25	52	75	0,12	
AFCR050030	HEK02-20.064 RP025	HF502-20.077	25	-	-	0,21	
AFCR060030	HEK02-20.077 RP025	HF502-20.077	25	70	95	0,29	
AFCR100030	HEK02-20.122 RP025	HF502-20.122	25	70	140	0,3	
AFCR100060	HEK02-20.122 MI060	HF502-20.122	60	70	140	0,3	
AFCR180010	HEK02-30.195 RP010	HF502-30.195	10	99	212	0,72	
AFCR180030	HEK02-30.195 RP025	HF502-30.195	25	99	212	0,72	
AFCR200010	HEK02-30.239 RP010	HF502-30.239	10	99	255	0,8	