

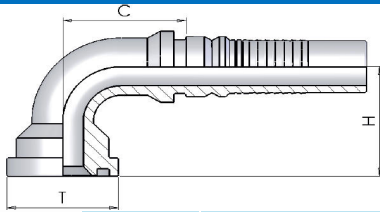

**R1050H**

90° COUDE BRIDE SAE 3000 PSI MONOBLOC  
90° SAE FLANGE 3000 PSI



Code	Type	Tuyau ID		Dimensions				
		in	mm	TAILLE	T	mm	H	C
R1050H1212	1050H12-12	3/4	19	12	3/4	38,1	52	52
R1050H1216	1050H12-16	3/4	19	12	1	44,5	56	55
R1050H1616	1050H16-16	1	25,4	16	1	44,5	65	73
R1050H1620	1050H16-20	1	25,4	16	1.1/4	50,8	71	69
R1050H2020	1050H20-20	1.1/4	31,8	20	1.1/4	50,8	78	93
R1050H2024	1050H20-24	1.1/4	31,8	20	1.1/2	60,3	80	97
R1050H2424	1050H24-24	1.1/2	38,1	24	1.1/2	60,3	95	100
R1050H2432	1050H24-32	1.1/2	38,1	24	2	71,4	101	134
R1050H3232	1050H32-32	2	50,8	32	2	71,4	121	122

AUTRES DIMENSIONS CONSULTER NOTRE SITE INTERNET / OTHER DIMENSIONS CONSULT OUR WEBSITE

**R1150H**

45° COUDE BRIDE SAE 3000 PSI MONOBLOC  
45° SAE FLANGE 3000 PSI

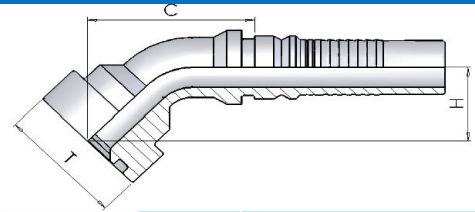

Code	Type	Tuyau ID		Dimensions				
		in	mm	TAILLE	T	mm	H	C
R1150H1212	1150H12-12	3/4	19	12	3/4	38,1	25	81
R1150H1216	1150H12-16	3/4	19	12	1	44,5	28	86
R1150H1616	1150H16-16	1	25,4	16	1	44,5	35	107
R1150H1620	1150H16-20	1	25,4	16	1.1/4	50,8	37	113
R1150H2020	1150H20-20	1.1/4	31,8	20	1.1/4	50,8	37	136
R1150H2024	1150H20-24	1.1/4	31,8	20	1.1/2	60,3	40	136
R1150H2424	1150H24-24	1.1/2	38,1	24	1.1/2	60,3	44	159
R1150H2432	1150H24-32	1.1/2	38,1	24	2	71,4	47	159
R1150H3232	1150H32-32	2	50,8	32	2	71,4	56	182

AUTRES DIMENSIONS CONSULTER NOTRE SITE INTERNET / OTHER DIMENSIONS CONSULT OUR WEBSITE

MATERIEL : ACIER (SUR DEMANDE : ACIER INOX AISI 316) - MATERIAL : STEEL (ON REQUEST : STAINLESS STEEL AISI 316°

**R1250H**

DROIT BRIDE SAE 3000 PSI MONOBLOC  
STRAIGHT SAE FLANGE 3000 PSI

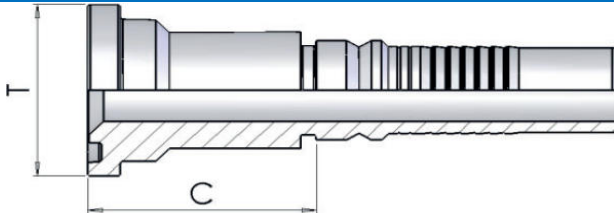

Code	Type	Tuyau ID		Dimensions			
		in	mm	TAILLE	T	mm	C
R1250H1212	1250H12-12	3/4	19	12	3/4	38,1	47
R1250H1216	1250H12-16	3/4	19	12	1	44,5	50
R1250H1616	1250H16-16	1	25,4	16	1	44,5	52
R1250H1620	1250H16-20	1	25,4	16	1.1/4	50,8	55
R1250H2020	1250H20-20	1.1/4	31,8	20	1.1/4	50,8	56
R1250H2024	1250H20-24	1.1/4	31,8	20	1.1/2	60,3	59
R1250H2424	1250H24-24	1.1/2	38,1	24	1.1/2	60,3	60
R1250H2432	1250H24-32	1.1/2	38,1	24	2	71,4	65
R1250H3232	1250H32-32	2	50,8	32	2	71,4	67

AUTRES DIMENSIONS CONSULTER NOTRE SITE INTERNET / OTHER DIMENSIONS CONSULT OUR WEBSITE

MATERIEL : ACIER (SUR DEMANDE : ACIER INOX AISI 316) - MATERIAL : STEEL (ON REQUEST : STAINLESS STEEL AISI 316°

**R1100H**

90° COUDE BRIDE SAE 6000 PSI MONOBLOC  
90° SAE FLANGE 6000 PSI

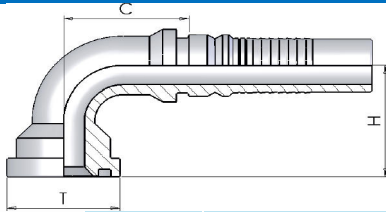

Code	Type	Tuyau ID		Dimensions				
		in	mm	TAILLE	T	mm	H	C
R1100H1212	1100H12-12	3/4	19	12	3/4	41,3	55	53
R1100H1216	1100H12-16	3/4	19	12	1	47,6	63	52
R1100H1612	1100H16-12	1	25,4	16	3/4	41,3	66	73
R1100H1616	1100H16-16	1	25,4	16	1	47,6	72	74
R1100H1620	1100H16-20	1	25,4	16	1.1/4	54	79,5	73
R1100H2016	1100H20-16	1.1/4	31,8	20	1	47,6	80	93
R1100H2020	1100H20-20	1.1/4	31,8	20	1.1/4	54	84,5	93
R1100H2024	1100H20-24	1.1/4	31,8	20	1.1/2	63,5	90	98
R1100H2424	1100H24-24	1.1/2	38,1	24	1.1/2	63,5	101	114
R1100H2432	1100H24-32	1.1/2	38,1	24	2	79,4	115	115
R1100H3232	1100H32-32	2	50,8	32	2	79,4	138	124

AUTRES DIMENSIONS CONSULTER NOTRE SITE INTERNET / OTHER DIMENSIONS CONSULT OUR WEBSITE

**R1200H**

45° COUDE BRIDE SAE 6000 PSI MONOBLOC  
45° SAE FLANGE 6000 PSI

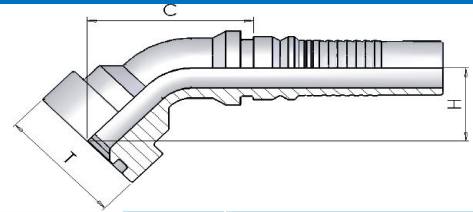

Code	Type	Tuyau ID		Dimensions				
		in	mm	TAILLE	T	mm	H	C
R1200H1212	1200H12-12	3/4	19	12	3/4	41,3	28	85
R1200H1216	1200H12-16	3/4	19	12	1	47,6	34	88
R1200H1612	1200H16-12	1	25,4	16	3/4	41,3	35	107
R1200H1616	1200H16-16	1	25,4	16	1	47,6	34	112
R1200H1620	1200H16-20	1	25,4	16	1.1/4	54	40	117
R1200H2016	1200H20-16	1.1/4	31,8	20	1	47,6	42	117
R1200H2020	1200H20-20	1.1/4	31,8	20	1.1/4	54	43	139
R1200H2024	1200H20-24	1.1/4	31,8	20	1.1/2	63,5	48	144
R1200H2424	1200H24-24	1.1/2	38,1	24	1.1/2	63,5	50	167
R1200H2432	1200H24-32	1.1/2	38,1	24	2	79,4	64	166
R1200H3232	1200H32-32	2	50,8	32	2	79,4	72	200

AUTRES DIMENSIONS CONSULTER NOTRE SITE INTERNET / OTHER DIMENSIONS CONSULT OUR WEBSITE

MATERIEL : ACIER (SUR DEMANDE : ACIER INOX AISI 316) - MATERIAL : STEEL (ON REQUEST : STAINLESS STEEL AISI 316°)

**R1300H**

DROIT BRIDE SAE 6000 PSI MONOBLOC  
STRAIGHT SAE FLANGE 6000 PSI

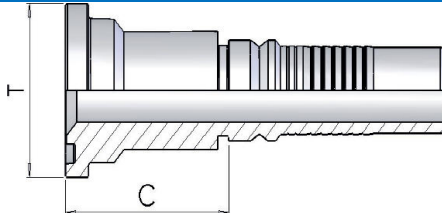

Code	Type	Tuyau ID		Dimensions			
		in	mm	TAILLE	T	mm	C
R1300H1212	1300H12-12	3/4	19	12	3/4	41,3	51
R1300H1216	1300H12-16	3/4	19	12	1	47,6	57
R1300H1612	1300H16-12	1	25,4	16	3/4	41,3	52
R1300H1616	1300H16-16	1	25,4	16	1	47,6	59
R1300H1620	1300H16-20	1	25,4	16	1.1/4	54	66
R1300H2016	1300H20-16	1.1/4	31,8	20	1	47,6	60
R1300H2020	1300H20-20	1.1/4	31,8	20	1.1/4	54	67
R1300H2024	1300H20-24	1.1/4	31,8	20	1.1/2	63,5	73
R1300H2420	1300H24-20	1.1/2	38,1	24	1.1/4	54	75
R1300H2424	1300H24-24	1.1/2	38,1	24	1.1/2	63,5	74
R1300H2432	1300H24-32	1.1/2	38,1	24	2	79,4	82
R1300H3232	1300H32-32	2	50,8	32	2	79,4	84

AUTRES DIMENSIONS CONSULTER NOTRE SITE INTERNET / OTHER DIMENSIONS CONSULT OUR WEBSITE

MATERIEL : ACIER (SUR DEMANDE : ACIER INOX AISI 316) - MATERIAL : STEEL (ON REQUEST : STAINLESS STEEL AISI 316°)

**R0110SH**

90° COUDE BRIDE SUPERCAT MONOBLOC  
90° 'CAT' FLANGE

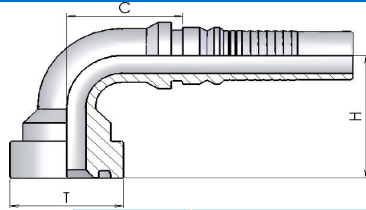

Code	Type	Tuyau ID		Dimensions				
		in	mm	TAILLE	T	mm	H	C
R0110SH1212	110SH12-12	3/4	19	12	3/4	41,3	62	51
R0110SH1616	110SH16-16	1	25,4	16	1	47,6	75	73,2
R0110SH1620	110SH16-20	1	25,4	16	1.1/4	54	82	74
R0110SH2020	110SH20-20	1.1/4	31,8	20	1.1/4	54	89	93
R0110SH2424	110SH24-24	1.1/2	38,1	24	1.1/2	63,5	100	115

AUTRES DIMENSIONS CONSULTER NOTRE SITE INTERNET / OTHER DIMENSIONS CONSULT OUR WEBSITE

**R0120SH**

45° COUDE BRIDE SUPERCAT MONOBLOC  
45° 'CAT' FLANGE

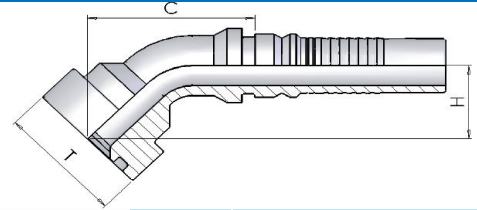

Code	Type	Tuyau ID		Dimensions				
		in	mm	TAILLE	T	mm	H	C
R0120SH1212	120SH12-12	3/4	19	12	3/4	41,3	30	89
R0120SH1616	120SH16-16	1	25,4	16	1	47,6	38	115
R0120SH2020	120SH20-20	1.1/4	31,8	20	1.1/4	54	47	142
R0120SH2424	120SH24-24	1.1/2	38,1	24	1.1/2	63,5	52	169

AUTRES DIMENSIONS CONSULTER NOTRE SITE INTERNET / OTHER DIMENSIONS CONSULT OUR WEBSITE

MATERIEL : ACIER (SUR DEMANDE : ACIER INOX AISI 316) - MATERIAL : STEEL (ON REQUEST : STAINLESS STEEL AISI 316°)

**R0130SH**

DROIT BRIDE SUPERCAT MONOBLOC  
STRAIGHT 'CAT' FLANGE

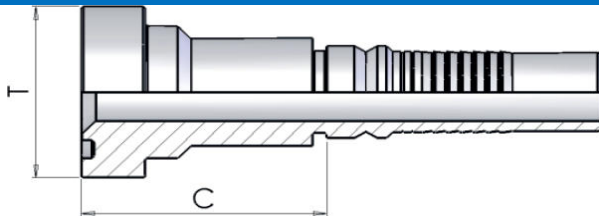

Code	Type	Tuyau ID		Dimensions			
		in	mm	TAILLE	T	mm	C
R0130SH1212	130SH12-12	3/4	19	12	3/4	41,3	55
R0130SH1216	130SH12-16	3/4	19	12	1	47,6	62
R0130SH1616	130SH16-16	1	25,4	16	1	47,6	63
R0130SH1620	130SH16-20	1	25,4	16	1.1/4	54	70
R0130SH2020	130SH20-20	1.1/4	31,8	20	1.1/4	54	71
R0130SH2424	130SH24-24	1.1/2	38,1	24	1.1/2	64	78

AUTRES DIMENSIONS CONSULTER NOTRE SITE INTERNET / OTHER DIMENSIONS CONSULT OUR WEBSITE

MATERIEL : ACIER (SUR DEMANDE : ACIER INOX AISI 316) - MATERIAL : STEEL (ON REQUEST : STAINLESS STEEL AISI 316°)